

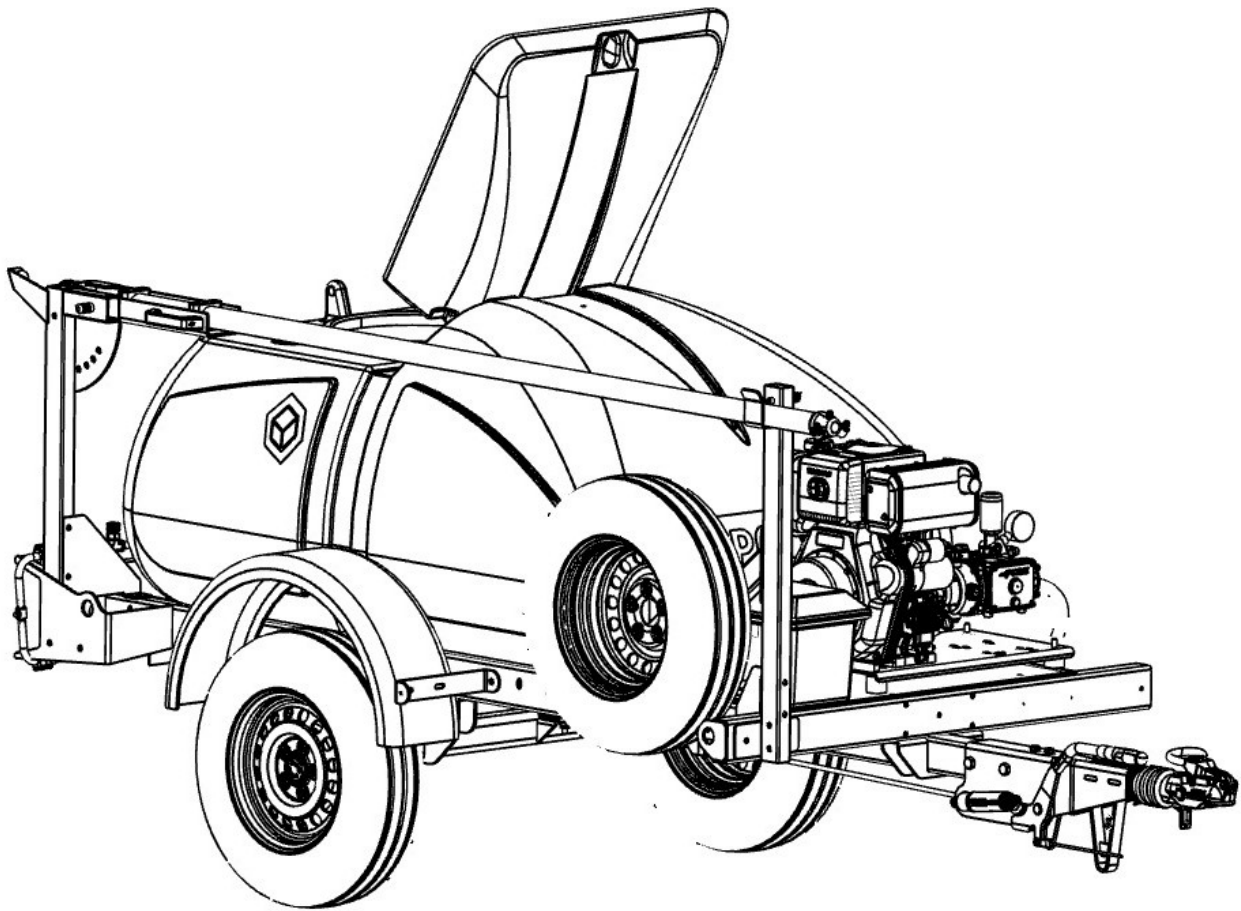

MULTIMISTER

PARTS MANUAL



MultiMister **MMRT-D-1000** Road Tow Portable
Dust Suppression Machines

service@dustquip.co.uk

REV012025

Part No: PM-MMRT-D-1000-SPEEDY

MMRT 4 IN 1 WATER BOWSER

MultiMister RT Bowser is a complete self-contained Diesel powdered dust, dirt and odour control bowser with pressure wash cleaning pump. The road tow 1100 ltr water bowser is an excellent tool for the construction site with its multi-purpose ability to keep a healthy and clean environment. The integrated unit can be deployed in minutes giving you immediate dust, odour or dirt control.

Mobility

Road towable 1000 Litre water bowser to EU specification for easy transporting with water. Totally self-contained dust suppression unit.



Spray Bar

Rear spray bar for road & haul route dust suppression.

Fogging Hose Lines

Optional 225m fogging hose with nozzles at 1m spacing for boundary suppression and odour control.



Diesel power

Yanmar diesel engine with electric start.

Protection

Heavy-duty galvanised chassis frame will last you in harsh environments.



Fold Down Mast

4 M high fold down mast for high reach misting.

Misting Hose Lines

Optional 25m misting hose with nozzles at 1m spacing for boundary suppression.



Quick scan
Operation video



MMRT 4 in 1 bowser

1. 1100 litre water bowser
2. 15 lpm / 200 bar pressure washer with 10m wash hose and trigger lance for construction equipment cleaning
3. 2.5m wide, rear spray bar for road cleaning or dust suppression
4. 4m high misting mast for high level dust suppression

Options

- 225m fogging hose line for boundary dust and odour control
- 25m misting hose for heavy dust control
- 25 litre neutraliser solution to dilute in water bowser for odour control
- Spare Wheel and bracket

When and where you need it

High pressure mist can be directed and particle size can be adjusted to suit all types of dust and wind direction.

The rear spray bar will keep roadways clean or damp and reduce the dust. The Optional misting or fogging hoses unit that can control odour and dust issues in remote locations.

PRODUCT SPECIFICATIONS

	MMRT-D-1100	MMRT-D-2000
Engine / Motor	Yanmar L100	Yanmar L100
Fuel Type	Diesel (HVO)	Diesel (HVO)
Fuel Tank Size - Ltr (USG)	5.4 (1.5)	5.4 (1.5)
Fuel Consumption Ltr/Hr (USG/Hr)	1 Ltr (0.25G)	1 Ltr (0.25G)
Emissions Standard	Stage V	Stage V
Power - Kw (HP)	6.8 (9)	10 (14)
Pressure - Bar (PSI)	-870	60 (870)
Flow Rate - LPM (USGPM)	15 (3)	15 (3)
Number of Mast Nozzles	3	3
Number of Rear Spray Bar Nozzles	7 (3M wide)	7 (3M wide)
Ave Mist water Droplet Size	180 µm	180 µm
Dimensions (LxWxH) - mm (inch)	"3500 x 1560 x 2150 (122" x 61" x 84")"	"3900 x 1850 x 1650 (154" x 73" x 65")"
Weight - Kg (Lbs) inc 1000 Ltr Water	1500 (3300)	3000 (6600)
Mist Distance (With Breeze) - M (Ft)	15m / 50 ft	15m / 50 ft
Std Mist Hose Length - M (Ft)	25m (82 Ft) at 1m (3Ft) Nozzle space 50m (164 Ft) @ 2m (6Ft) Nozzle space	
Std Fog Hose Length - M (Ft)	225m (738 Ft) at 1m (3Ft) Nozzle space	
Max Water Feed Pressure - Bar (PSI)	3 Bar (43)	
Warranty Period	12 Months	
Fork Lift Facility	Option for empty tank	
Water Quality	Drinking Water Quality	
Trailer Max Axle Capacity - Kg	1500 (3300)	3000 (6600)
Water Tank Capacity Ltr (USG)	1000 (260)	2000 (520)

GENERAL (Chassis)

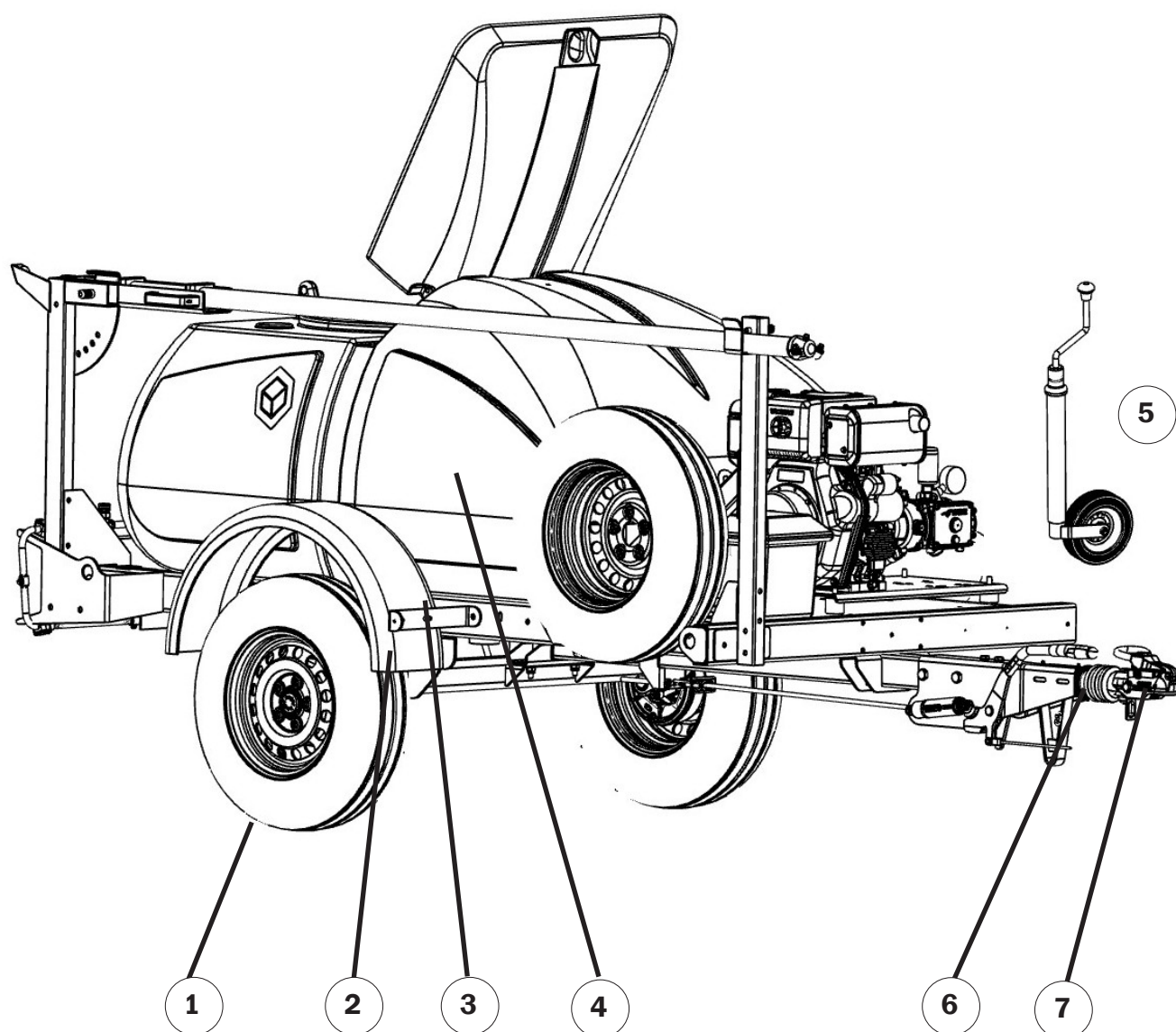

Number	Description	Part Number	Qty
1	Wheel & Tyre Assembly	RGC022/1	3
2	Plastic Mudguard	RGC016	2
3	Mudguard Bracket	RGC052	4
4	Tank Lid & Vent	T009	1
5	Jockey Wheel	RGC004	1
6	Breakaway Cable	RGC020	1
7	50mm Ball Coupling Head (option)	RGC047	1
7	50mm Eye Coupling Head (option)	RGC049	1

GENERAL (Lighting)

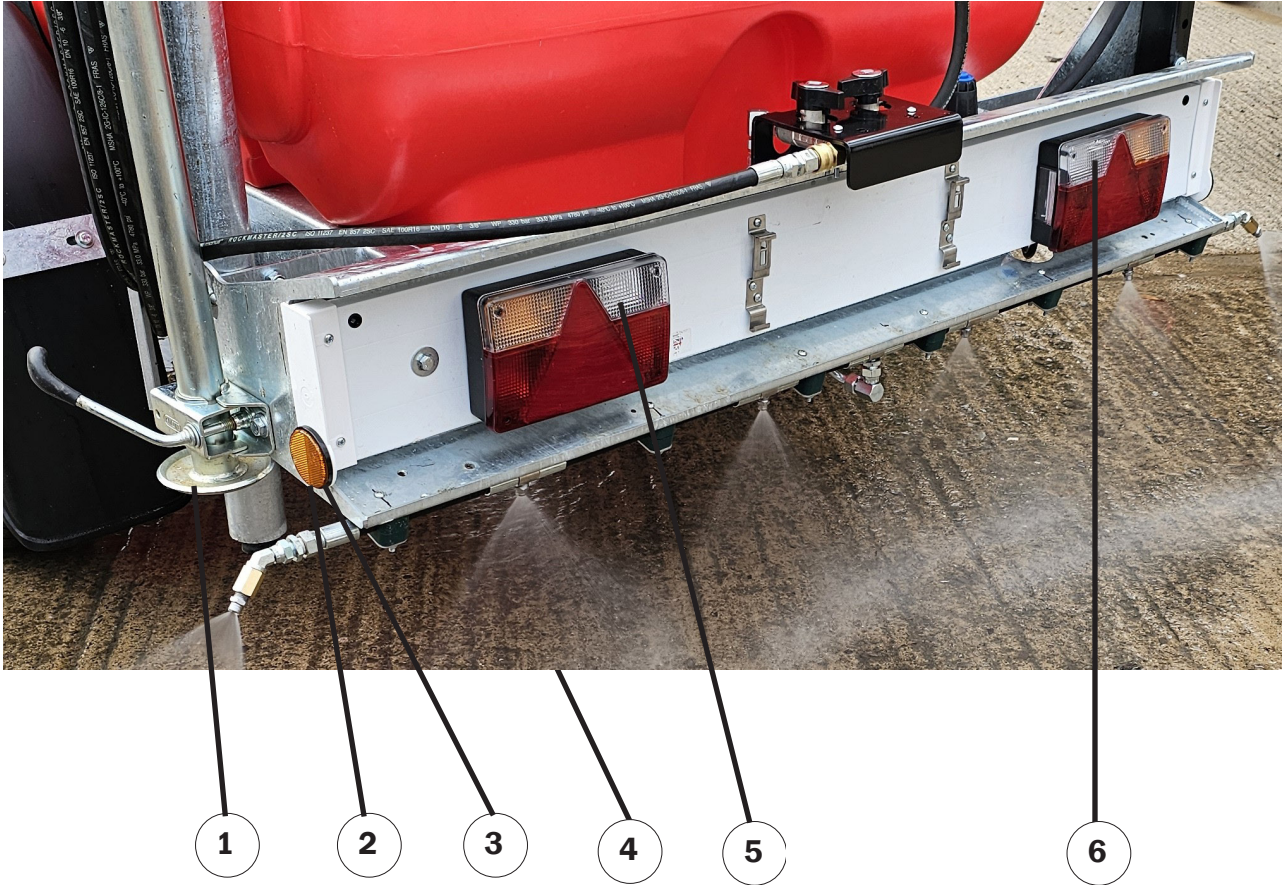

Item	Description	Part Number	Quantity
1	Propstand Leg 42mm x 600mm	RGC013	1
2	Reflector round clear (white)	RGC041	4
3	Reflector round (amber)	RGC032	4
4	Lighting Board Complete	RGC015	1
5	Rear Light Lens (NS)	RGC050	1
6	Rear Light Mens (OS)	RGC051	1

SPRAY MAST

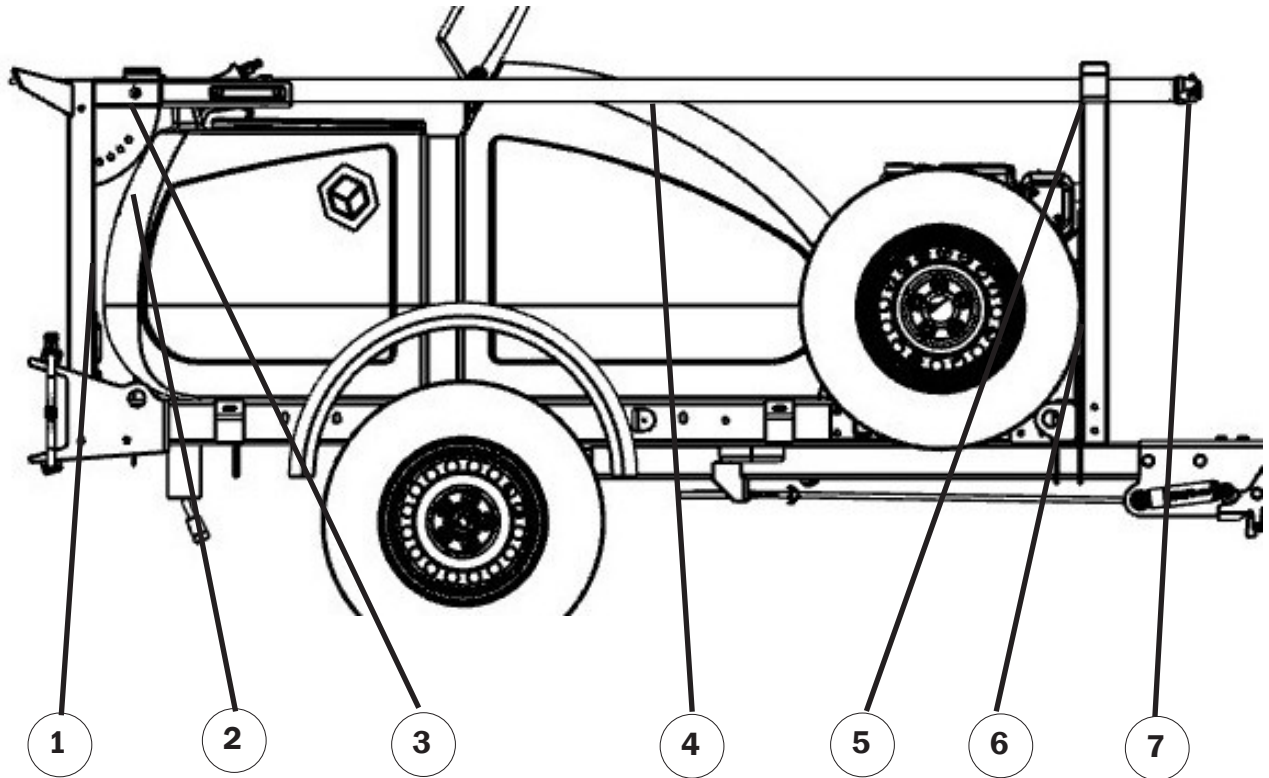

Item	Description	Part Number	Quantity
1	Rear Support Post	MMRT-01	1
2	Mast Bracket	MMRT-02	1
3	Sword Pin - Lower Locking	IM080	1
	Mast Hose Assembly	HA043	1
4	Replacement Spray Mast	MMRT-04	1
5	Locking Pin (support post)	IM001	1
6	Spray Mast Support Post	MMRT-03	1
7	Mist Head (without nozzles)	MMRT-05	1
	Nozzle Mounting Elbow	HF-ELBOW-1/4-M/F-BRASS	2
	Spray Jet Nozzle 25 Deg	WG-NOZZLE-2502	2
	Spray Jet Nozzle 40 Deg	WG-NOZZLE-4002	1

SPRAY BAR & LANCE



Number	Description	Part Number	Qty
1	Spray Mode Selection Module with hoses	MMRT-15	1
2	Pressure Gauge	HF-GAUGE-250BAR	1
3	Pressure Valve	HF-UNLOADER-VRT3	1
4	Spray Bar Assembly	JMRT-SPRAY-BAR-1000	1
5	ST60 Chemical Injector	HF-CHEM-INJ	1
6	Spray Bar Clamp	IM044 & IM045	4



Number	Description	Part Number	Qty
1	Pressure Wash Kit Complete	JMRT35-PWK	1
2	Replacement Hose (10 Meter)	HA007	1
3	Lance, Gun, Protector & Nozzle	WH-LANCE-1/4-1512	1

ENGINE/PUMP

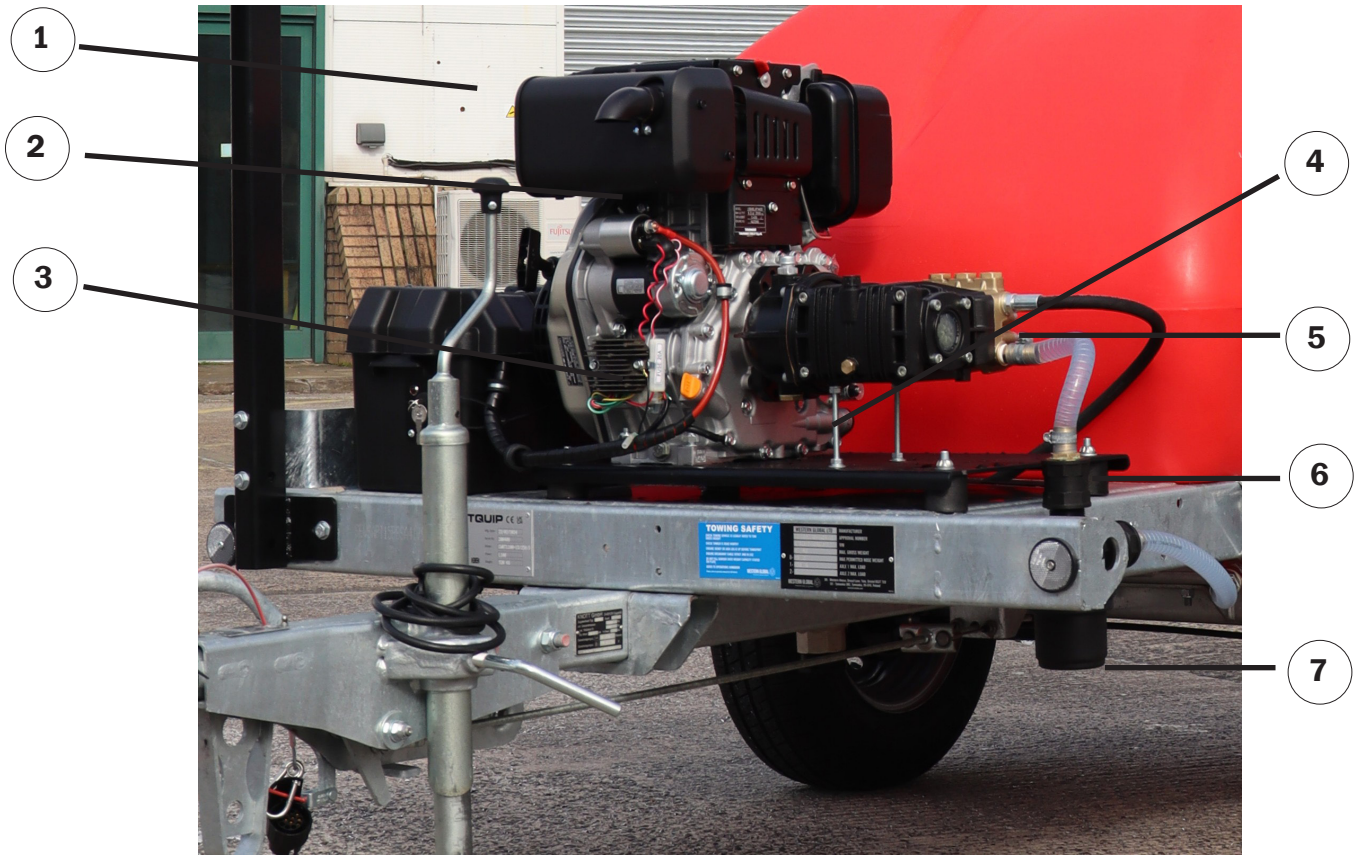

Number	Description	Part Number	Qty
1	Complete Engine/Pump Assembly	PUA-15-200-D	1
2	Fuel Injector (under cover)	MPC-011	1
3	Voltage Regulator	MPC-000	1
4	Oil Filter	MPC-013	1
5	Replacement HP Pump	PU024	1
6	Suction Filter	PW-FILTER-SUCTION-1-1.4" M-BLUE	1
	Engine Service Kit (Includes all oils)	MPC009	1
9	Main Tank Valve	PW-VALVE-FF-3/4	1

ENGINE/PUMP

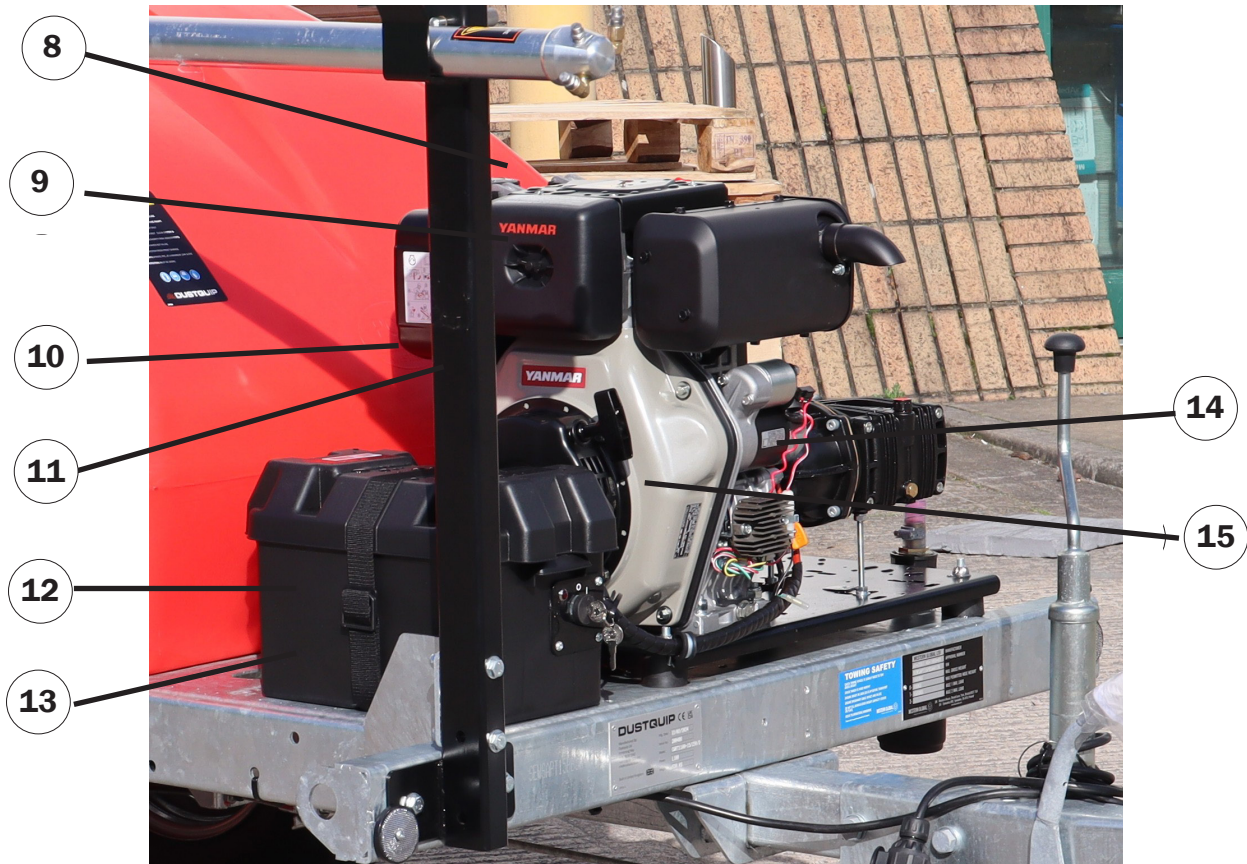

Number	Description	Part Number	Qty
8	Fuel Cap	MPC014	1
9	Yanmar Air Filter	MPC-015	1
10	Fuel Filter	MPC-012	1
11	Fuel Pump (Back of engine)	MPC-010	1
12	Battery Box	EA084	1
13	12v Battery	EC020	1
14	Starter Motor	MPC-019	1
15	Recoil Pull Start Assembly	MPC-036	1

FACTORY SERVICE

Maintenance Matters : Downtime Deters

Part No: DFS-MMRT-D-1000

Maintenance is key to running efficient and reliable equipment.

Take advantage of the DFS (Dustquip Factory Service) , so you can focus on the running of your business, while trusting us to expertly maintain your machines.

The **DFS** is tailored to suit your machine and includes:



- Full test run & report
- Pressure wash clean
- Engine : Oil & filter change
- Gearbox: Oil check
- Pump: Oil check & top up
- Spray Mast: Lubrication service and spray jets checked

Terracore Group Ltd
TA Dustquip

+44(0) 1454 513 000

Quercus Court
Armstrong Way
Yate
BS37 5NG

www.dustquip.co.uk
info@dustquip.co.uk

Parts & Service - email: service@dustquip.co.uk